

- NOTES:
1. SEE DRG. WZTC-01 FOR PERTINENT VARIABLE MESSAGE SIGN MESSAGES.
 2. CONTRACTOR SHALL PROVIDE PORTABLE VARIABLE MESSAGE SIGN AND PUT IN OPERATION PRIOR TO THE START OF CONSTRUCTION. TO DETOUR CONSTRUCTION SHALL CHANGE MESSAGE IN FIRST WITH DETOUR IS BEING OPENED AND IN SECOND WITH DETOUR IS BEING CLOSED.
 3. SEE DRG. WZTC-04 FOR SIGN PANEL NUMBERS AND SIZES.

LEGEND	
	DETOUR ROUTE
	DIRECTION OF TRAFFIC
	ROAD AND DRIVE CLASSIFICATION
	CONSTRUCTION SIGN
	PORTABLE VARIABLE MESSAGE SIGN
	TYPED & PLACED SIGN
	TYPE & PLACED SIGN

750 1000
 1" = 100'
 SCALE IN FEET

MATCH LINE "A", SEE DWG WZTC-02

WZTC-03 SHEET 03 OF 31	DETOUR PLAN (2 OF 2)			CBS COMPANIES CBS Engineers, Inc. 400 West 125th Street New York, NY 10019 Phone: 212-425-2000 Fax: 212-425-2001 www.cbs.com			PNR 2754.51 BSN 2269270	D036141	REVISIONS NO. DATE BY REVISIONS	DRAWN BY: [] CHECKED BY: [] DATE: []	PROJECT NO.: [] SHEET NO.: [] SHEET TOTAL: []	CONTRACT NO.: [] PROJECT NAME: [] PROJECT LOCATION: []	PROJECT OWNER: [] PROJECT MANAGER: [] PROJECT ENGINEER: []	PROJECT ARCHITECT: [] PROJECT ENGINEER: [] PROJECT SURVEYOR: []	PROJECT DESIGNER: [] PROJECT ENGINEER: [] PROJECT SURVEYOR: []	PROJECT CONTRACTOR: [] PROJECT ENGINEER: [] PROJECT SURVEYOR: []
									<h3 style="text-align: center;">REPLACEMENT OF NEW BOSTON STREET BRIDGE OVER OWLVILLE CREEK TOWN OF LENOX, NY MADISON COUNTY</h3>							

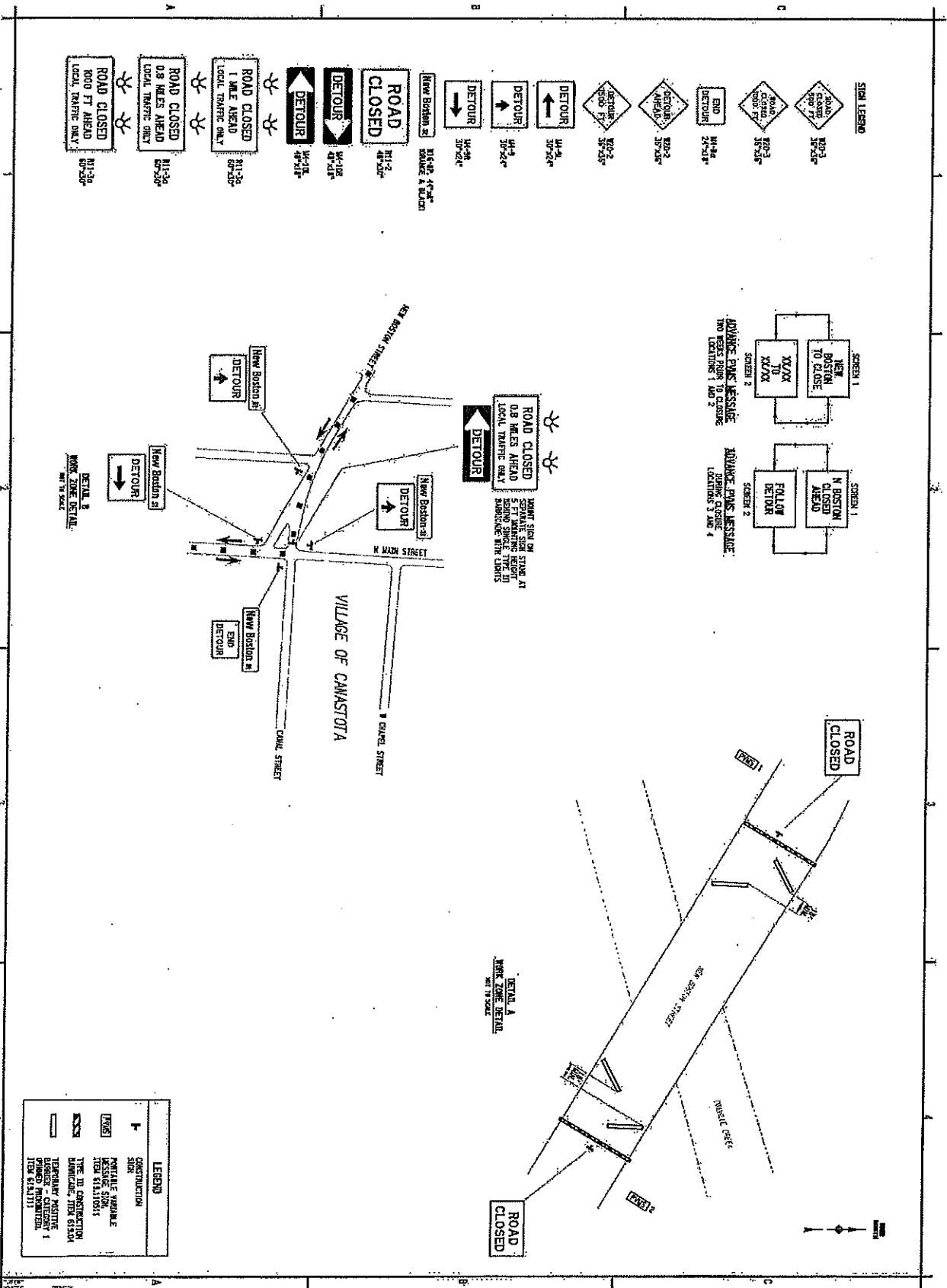

WZTC-04
SHEET 10 OF 25

**REPLACEMENT OF
NEW BOSTON STREET BRIDGE
OVER OWLVILLE CREEK
TOWN OF LENOX, NY
MADISON COUNTY**

FIN 2254.51
BIN 2265270

CGS
COMPANIES

CGS Engineers, Inc.
490 Oak Street, Suite 404
Lenox, NY 12548-1000
Phone: 518-535-2000
Fax: 518-535-2007
www.cgs.com

NO.	DATE	REVISION

NO.	DATE	REVISION

NO.	DATE	REVISION