

TOWN OF LENOX
FIRE MARSHAL'S OFFICE

DEPARTMENT OF PUBLIC SAFETY
CODE ENFORCEMENT OFFICE
FIRE MARSHALS OFFICE
Timothy S. Cowan
Code Enforcement Officer
Fire Marshal

205 Peterboro Street
Canastota, NY 13032
TEL: 315-697-5575
FAX: 315-697-5514
tolfire@cnymail.com
www.lenoxny.com

SOLID FUEL BURNING DEVICE PERMIT APPLICATION

- OWNER: _____
- ADDRESS: _____
- TAX MAP #: _____
- PHONE NUMBER: _____
- TYPE OF UNIT: (circle one) fireplace woodstove coal stove pellet stove propane stove other
- MANUFACTURE: _____
- MODEL# _____ SERIAL# _____
- BTU RATING: _____
- COMBUSTION CHAMBER SIZE: WIDTH _____ DEPTH _____ HEIGHT _____
- ROOM OF USE: _____ FLOOR OF USE: _____
- CHIMNEY TYPE: (circle one) block/flue brick/flue double wall triple wall
- THREE SCREWS OR RIVETS IN EVERY JOINT (circle one) yes no
- DOES THE FLUE SERVE ANY OTHER APPLIANCES? (circle one) yes no
- IS THERE AN AIRTIGHT CLEAN-OUT DOOR ON THE CHIMNEY? yes no
- TYPE & SIZE OF NON-COMBUSTIBLE HEARTH _____
- STOVE CLEARANCES: LEFT SIDE _____ RIGHT SIDE _____ FRONT _____
TOP _____ FLOOR _____
- HAS THERE EVER BEEN A CHIMNEY FIRE IN THE PAST? yes no unknown



- ARE SMOKE DETECTORS OPERATIONAL, ADJACENT TO, AND IN ALL SLEEPING AREAS? yes no unknown
- IS THERE AN OPERATIONAL CO DETECTOR ON THE LOWEST SLEEPING LEVEL? yes no unknown
- INSTALLATION IS; APPROVED or REJECTED (circle one)
- COMMENTS: _____

- COST; **\$10.00**

Applicant Signature

Inspectors Signature

Date

The issuance of this permit does not take the place of any license required by law and is NON-TRANSFERRABLE. By approving a permit, the Town of Lenox or its designated officers will accept NO responsibility.



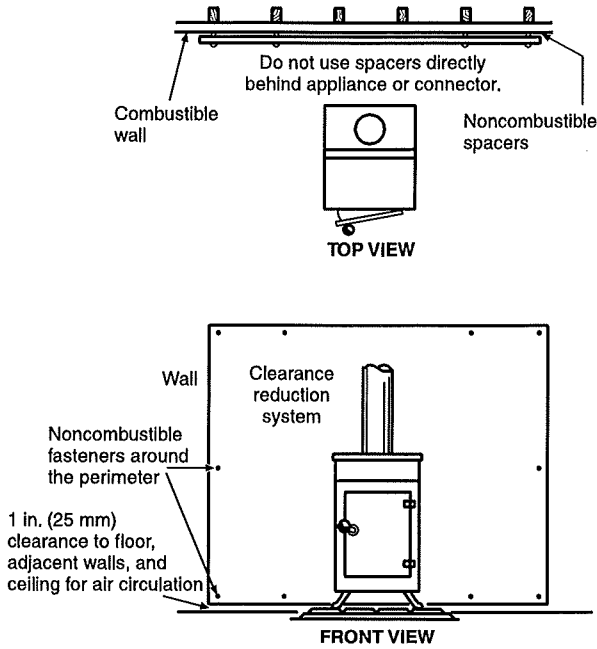

FIGURE 13.6.2.1(a) Clearance Reduction System — Fastener Location.

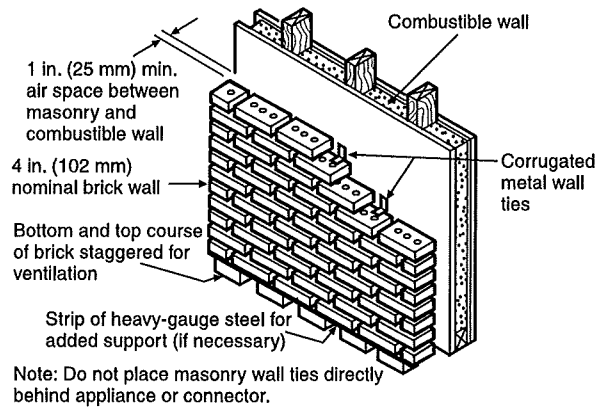

FIGURE 13.6.2.1(c) Masonry Clearance Reduction System.

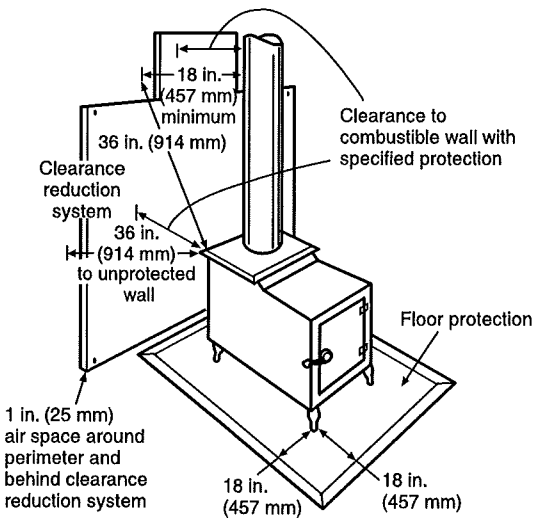
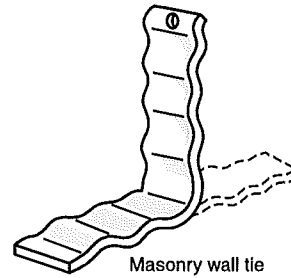
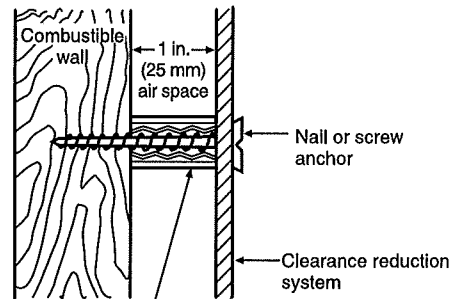

FIGURE 13.6.2.1(b) Distance to Combustible Wall/Floor.



1 in. (25 mm) noncombustible spacer such as stacked washers, small-diameter pipe, tubing, or electrical conduit

Notes:

- (1) Masonry walls can be attached to combustibile walls using wall ties.
- (2) Do not use spacers directly behind appliance or connector.

FIGURE 13.6.2.1(d) Fastener Detail.

**TOWN OF LENOX
FIRE MARSHAL'S OFFICE**

DEPARTMENT OF PUBLIC SAFETY
CODE ENFORCEMENT OFFICE
FIRE MARSHALS OFFICE
Timothy S. Cowan
Code Enforcement Officer
Fire Marshal

205 Peterboro Street
Canastota, NY 13032
TEL: 315-697-5575
FAX: 315-697-5514
tolfire@cnymail.com
www.lenoxny.com

To: Solid Fuel Burning Device Applicants

From: Town of Lenox Fire Marshal

Subject: Smoke and Carbon Monoxide Detectors

Pursuant to the 2015 International Property Maintenance Code;

Section 704.2.1.1. Single- or multiple-station smoke alarms shall be installed and maintained in all of the following locations in Group R (residential) occupancies:

1. In sleeping areas.
2. In every room in the path of the *means of egress* from the sleeping area to the door leading from the *sleeping unit*.
3. In each story within the *sleeping unit*, including basements. For *sleeping units* with split levels and without an intervening door between the adjacent levels, a smoke alarm installed on the upper levels, a smoke alarm installed on the upper level shall suffice for the adjacent lower provided that the lower level is less than one full story below the upper level.

Pursuant to the 2015 International Fire Code;

Section 915.2.3.1.2. Buildings constructed prior to January 1, 2008. A carbon monoxide alarm shall be provided on the lowest story containing a sleeping area, within 15 feet of the sleeping area. More than one carbon monoxide alarm shall be provided where necessary to assure that no sleeping area on such story is more than 15 away from a carbon monoxide alarm.

Section 915.2.3.2.1. Buildings constructed on or after January 1, 2008. A carbon monoxide alarm shall be provided on the lowest story containing a sleeping area, within 15 feet of the sleeping area. More than one carbon monoxide alarm shall be provided where necessary to assure that no sleeping area on such story is more than 15 away from a carbon monoxide alarm.

Section 915.2.3.2.1.2. A carbon monoxide alarm shall be provided on every story that contains a carbon monoxide source.

Along with meeting the conditions of the solid fuel burning device permit application, the appropriate number of smoke and carbon monoxide alarm shall be installed and in working order at the time of inspection.

